

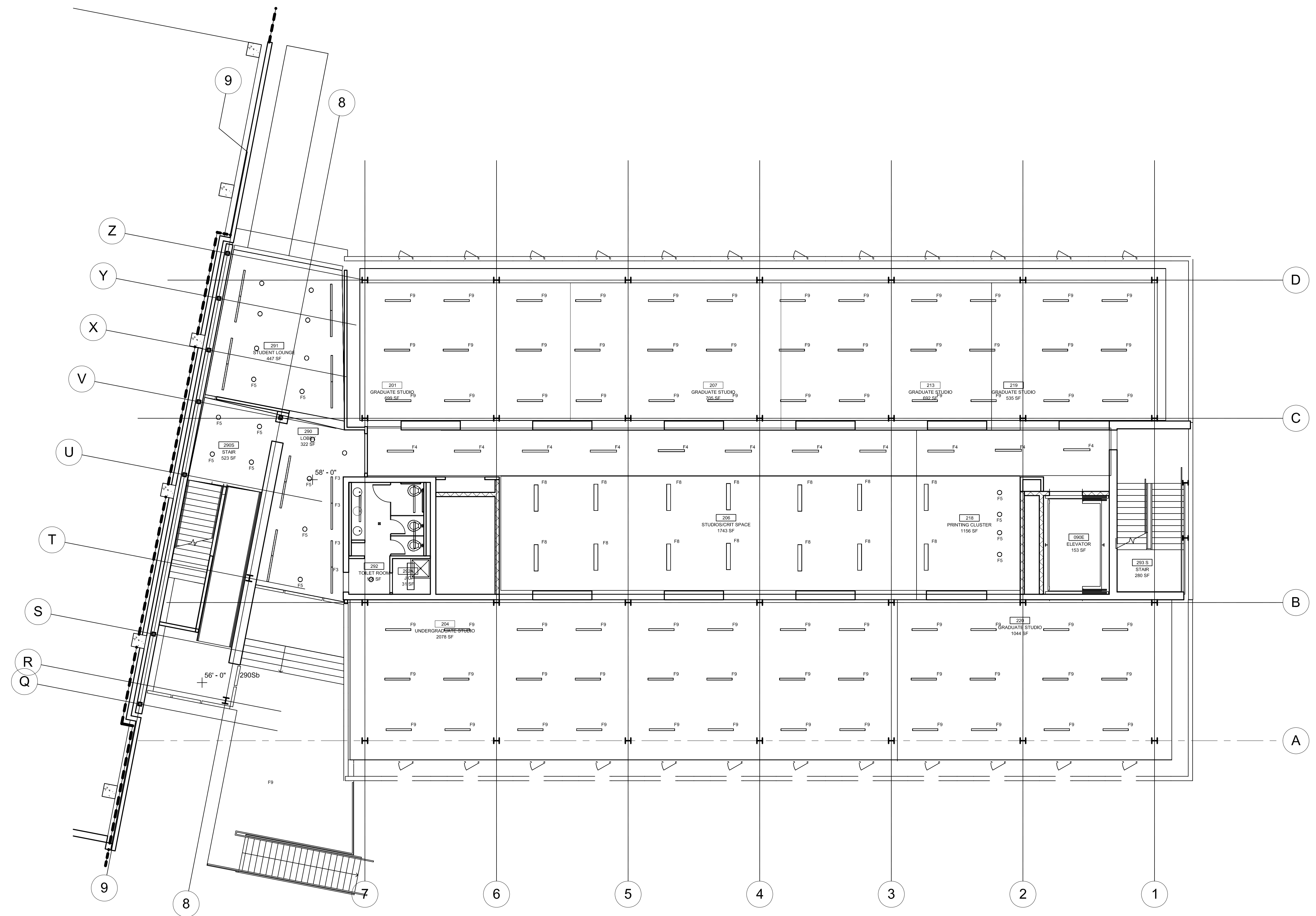

Thesis 2007  
 Pennsylvania State University  
 State College, PA 06802

KHA N DANG, LC INTERN  
 ARCHITECTURAL ENGINEERING  
 LIGHTING | ELECTRICAL option  
 T: 267 229 9370  
 E: knd107@gmail.com  
 W: www.arch.psu.edu/thesis/portfolio/2007/  
 /portfolios/knd107  
 C: Dr. Richard Mistrick  
 C2: Ted Damerth



Symbol	Level	Qty	Code/Number	Description	Notes	Watt	Lumens	LF	Watts
[Symbol]	F1	1	PV 2-4THRD	HEAVY DUTY INDUSTRIAL 12" X 4" 2 BAY TROUSER W/SLIT SCOTCH REFLECTOR	INDIRECT FLUORESCENT BAYED 400 LUMENS	171.920LBS	4850	0.75	102.6
[Symbol]	F2	0	EGCMB-2-4THRD	F 2 2' X 2' ALUMINUM DIRECT INDIRECT LIGHT WITH ADJUSTABLE TRIM	DIFFUSED BAYED @ 3000 LUMENS	np4252.0m	5000	0.81	120.4
[Symbol]	F3	18	EWMB-1-4THRD	F 3 1' X 2' ALUMINUM DIRECT INDIRECT LIGHT WITH ADJUSTABLE TRIM	DIFFUSED BAYED @ 3000 LUMENS	np9154.0m	4850	0.81	88.9
[Symbol]	F4	11	LEMB-1-4THRD	F 4 1' X 2' ALUMINUM DIRECT LIGHT WITH IMPERMEABLE	DIFFUSED BAYED @ 3000 LUMENS	LP9934.0m	5000	0.81	101.1
[Symbol]	F5	22	SPC	1" LENSED DOWNLIGHT WITH HONEY COMB REFLECTOR, 120VTR HORIZONTAL LAMP, PRISM LENS AND SOFT RECESSED JOINT	ONE 30-WATT COMPACT FLUORESCENT TUBE TUBE HORIZONTAL POOL	L7L14618.0LBS	2400	0.75	34
[Symbol]	F6	0	MIMB2 2-4THRD	FLUORESCENT RECESSED 2' X 4' 2 BAY TROUSER W/SLIT SCOTCH REFLECTOR, 120VTR HORIZONTAL LAMP, PRISM LENS AND SOFT RECESSED JOINT	TWO 34-WATT T8 48" TUBES @ 3000 LUMENS	L81008.0m	4850	0.75	124
[Symbol]	F7	0	EGCMB-2-4THRD	F 7 2' X 2' ALUMINUM DIRECT INDIRECT LIGHT WITH ADJUSTABLE TRIM	DIFFUSED BAYED @ 3000 LUMENS	np4252.0m	5000	0.75	120.4
[Symbol]	F8	14	EMMB-2-4THRD	F 8 2' X 2' ALUMINUM DIRECT INDIRECT LIGHT WITH IMPERMEABLE	DIFFUSED BAYED @ 3000 LUMENS EACH	np4252.0m	5000	0.75	120.4
[Symbol]	F9	23	NPSCMR-REF-2ND-4THRD	EXTRUDED ALUMINUM TROUSER W/SLIT SCOTCH REFLECTOR, 120VTR HORIZONTAL LAMP, PRISM LENS AND SOFT RECESSED JOINT	TWO 34-WATT T8 48" TUBES @ 3000 LUMENS	np4252.0m	4850	0.75	98

Name	# Luminaires	Total Watts	Area	Density
Basement	4	2137.0W	102.5 SF	1.4 W/FP
Corridor	11	861.1W	876.7 SF	0.9 W/FP
Off Space	18	1601.6W	1368.0 SF	1.2 W/FP
Janitor Closet	1	123.6W	31.2 SF	3.9 W/FP
Rest	17	782.2W	472.9 SF	1.7 W/FP
Power Quality Control 2	36	3964.0W	309.8 SF	1.3 W/FP
Power Quality Control 4	17	782.2W	472.9 SF	1.7 W/FP
Student Lounge	16	751.2W	429.9 SF	1.7 W/FP
Stair	6	864.0W	308.4 SF	2.8 W/FP

Description	Symbol	Area	Watts	Watts/Sq Ft	Watts/Ft
Basement	+	13.8%	31.3%	4.5%	0.51
Corridor	+	16.8%	24.4%	0.9%	0.14
Off Space	+	15.4%	34.4%	5.0%	3.11
Janitor Closet	+	30.1%	31.2%	20.3%	1.11
Rest	+	26.2%	83.2%	7.9%	3.61
Student Lounge	+	39.3%	50.8%	16.2%	0.81
Stair	+	41.4%	86.8%	7.3%	0.71
Stair B	+	43.1%	90.7%	8.0%	0.81

**NOTE:**

While great efforts have been taken to provide accurate and complete information, please be aware that the information contained herewith is considered a work-in-progress for this thesis project. Modifications and changes related to the original building designs and construction methodologies for this senior thesis project are solely the interpretation of Kha N. Dang. Changes and discrepancies in no way imply that the original design contained errors or was flawed. Differing assumptions, code references, requirements, and methodologies have been incorporated into this thesis project; therefore, investigation results may vary from the original design.

**NOT FOR CONSTRUCTION**

NO.	DATE	REVISION

PROJECT NAME  
**THESIS 2007  
 SCULPTURE BIDG  
 PARKING GARAGE**  
 BUILDING NAME & ADDRESS  
 PROJECT NUMBER

DRAWING TITLE  
 TYP. 2-4 FLOORS LIGHTING LAYOUT  
 SCALE  
 1/8" = 1'-0"  
 DRAWN BY  
 KND  
 CAD FILENAME  
 XX-XX-XXX.DWG  
 DATE  
 03/11/07  
 DRAWING NUMBER  
**EL-300**